

**THE 2022 REMI SHOW, IFMA GLOBAL CANADA,
CAI CANADA CONFERENCE AND ISSA SHOW | JUNE 8TH-9TH, 2022**

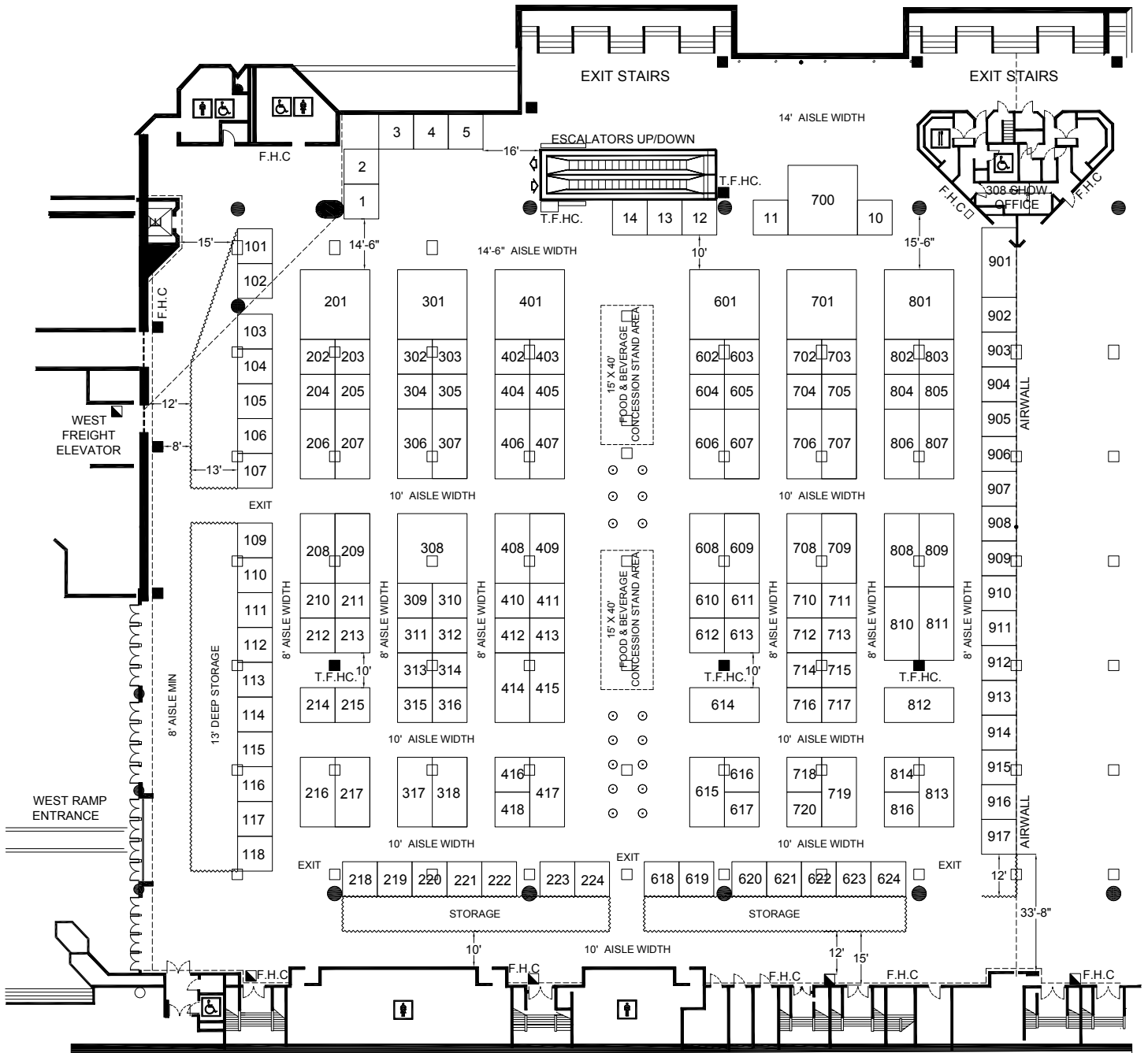

Questions, Ready to Book?

Please contact your exhibit team:

Chuck Nervick | Senior Vice President

Email: chuckn@mediaedge.ca | Office: 416-512-8186 x 227

www.REMIshow.com

For Office Use	
Booth(s) Assigned:	_____
Square Ft:	_____
Booth Cost: \$	_____
HST (13%): \$	_____
Total (Cdn.): \$	_____

CONTRACT FOR EXHIBIT SPACE

June 8 - 9, 2022 | Metro Toronto Convention, Toronto, Ontario, Canada

This Agreement for exhibit space at the event ("Show") is made between the REMI Show ("Show Management") and the company listed below ("Exhibitor"): Exhibiting Company Name (EXACTLY AS IT IS TO APPEAR IN SHOW GUIDE & WEBSITE EXHIBITOR LISTING):

Address 1 _____

Address 2 _____

City _____ Province/State _____ Postal/Zip Code _____

Phone _____ Fax _____ Website _____

Key Contact _____ Direct Phone _____

Title _____ Email _____ Cell _____

Booth Choice #1 _____ #2 _____ #3 _____ Booth Size _____

Company Social Media Links: Twitter: @ _____ Instagram: @ _____

LinkedIn: _____ Facebook: _____

PAYMENT INFORMATION

- Cheque Credit Card
- VISA MASTERCARD AMERICAN EXPRESS

Card Number _____

Expiry Date _____

Name of Cardholder _____

Amount (Cdn.) \$ _____

Signature _____

EXHIBIT DESIGN GUIDELINES:

In order to maintain a high quality appearance, all exhibits must feature backwalls of a "hardwall" or "pop-up" nature. Curtains will only exist for masking purposes. Hanging banners from the curtains or otherwise relying on the drape for your backdrop is prohibited. Your backwall and its contents must not exceed 8 ft. Sidewalls may be up to 8 ft., but only if located 3 ft. from the backwall – after which they must taper or drop to 3 ft. Do not obstruct your neighbours! Please note that there is an 8 ft. height limitation on the display and equipment for all single and double in-line booths, unless authorized prior to the show by show management. Display rules for multiple and perimeter booths will be included in the Exhibitor Service Manual.

I accept the terms and conditions herein and acknowledge that this shall become a binding contract upon acceptance and co-signature by MediaEdge Communications Inc. on behalf of REMI Show:

Authorized Signature _____

Print Name _____

Company Name _____

Date _____

SEND CHEQUES PAYABLE TO:

REMI Show
 c/o MediaEdge Communications Inc.
 2001 Sheppard Avenue East, Suite 500, Toronto, ON M2J 4Z8
 Phone: 416-512-8186 x280 Fax: 416-512-8344

EXHIBIT SPACE RATES

(PER 10' X 10' BOOTH IN CDN. DOLLARS PLUS TAX):

	Member Rate	Non-member Rate
1 booth	\$2,350	\$2,600
2-4 booths	\$2,250/booth	\$2,500/booth
5-9 booths	\$2,150/booth	\$2,400/booth
10+ booths	\$2,050/booth	\$2,300/booth

PAYMENT SCHEDULE:

50% due with this Contract
 Balance of 50% due by April 8, 2022

TERMS AND CONDITIONS:

Should the exhibitor cancel or otherwise breach the terms of this agreement, all payments received by show management are non-refundable and the total space fees remain due in full. The exhibitor accepts and will comply with the rules and regulations in this agreement and in the exhibitor service manual. Show management reserves the right to relocate the assigned exhibitor booth(s) to an alternate space or to relocate the show to an alternate location. Such relocations shall not relieve the exhibitor of their obligations. If the 2022 show is cancelled and rescheduled to a 2023 date, the exhibitor will be required to pay a 50% deposit equal to their total booth costs to hold their 2023 booth space following the payment schedule in this agreement. The 50% deposit payment will secure the exhibitor's booth space and will be applied in full to the 2023 Show. The remaining 50% balance is due within 120 days of the new show date in 2023. If an exhibitor has paid 100% of their total booth fees prior to the show moving to a new date in 2023, those fees will be applied in full to the new show date in 2023 with no further payments required. The exhibitor also has the option to receive a refund on any monies paid over the 50% deposit fee amount, but the 50% deposit will still be retained to hold the space for 2023. The exhibitor agrees to carry a minimum of \$2,000,000 commercial general liability insurance, naming the Metro Toronto Convention Centre (MTCC), the REMI Show, CAI Canada Conference and IFMA Show Canada as additional insureds for the duration of the show from move-in through move-out. The exhibitor agrees to conduct all business at the show in accordance with the Occupational Health and Safety Act as outlined by the appropriate Provincial Ministry of Labour.

Questions? Please contact Chuck Nervick at 416-803-4653 or chuckn@mediaedge.ca